

EMI Connector Gaskets

EMI FLANGE SEALS FOR ELECTRICAL CONNECTORS

U.S. Customary
[SI Metric]

GENERAL DESCRIPTION

A variety of TECKNIT EMI shielding materials can be manufactured into connector gaskets for military and commercial applications. These materials include TECKNIT CONSIL® materials, TECKFELT™, DUOLASTIC™, TECKSPAN™, and ELASTOMET®. Each TECKNIT material has its own advantages and characteristics. The gaskets can be manufactured to provide shielding only or a combination of shielding and environmental sealing. Tests have shown total shielding effectiveness of 100 dB or greater can be achieved with these TECKNIT materials.

STANDARD FOR DIMENSIONING CONNECTOR GASKETS

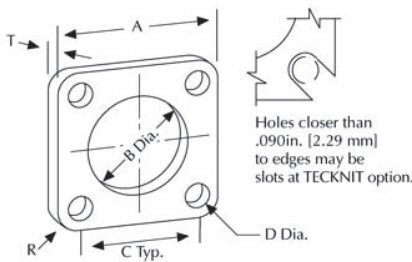
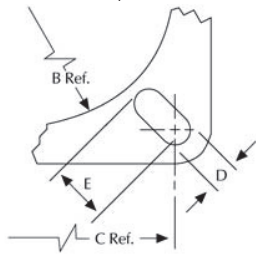

Figure 1.

Figure 2. MIL-C-38999 Series III only.



ORDERING INFORMATION

To order TECKNIT connector gaskets, first select the Material Part Number Prefix. Second, locate the required gasket dimension from Table II or III and record the TECKNIT Order Number or Suffix. Third, combine the Material Prefix Number with the Order Number to obtain the complete TECKNIT Part Number which can be used to order gaskets. For assistance, or to determine the availability of connector gaskets not listed here, contact your nearest TECKNIT representative or factory location.

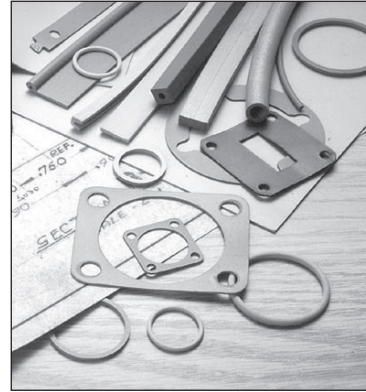

SPECIFICATIONS

STANDARD MATERIALS* (part # prefix)	EMI SEAL	SEALING ELASTOMER	THK. (see Fig. 1) in. [mm]
DUOLASTIC			
(42-6xxxx)	Aluminum	Silicone	.020 [0.51]
(42-8xxxx)	Aluminum	Neoprene	.020 [0.51]
TECKFELT			
(45-6xxxx)	Stainless Steel	Silicone	.030 [0.76]
TECKSPAN			
(48-6xxxx)	Monel	Silicone	.030 [0.76]
(48-8xxxx)	Aluminum	Silicone	.030 [0.76]
ELASTOMET			
(82-6xxxx)	Monel	Silicone	.030 [0.76]
(82-7xxxx)	Phosphor, Bronze	Silicone	.030 [0.76]
(82-8xxxx)	Aluminum	Silicone	.030 [0.76]
CONSIL-II (842)			
(84-6xxxx)	Silver-plated inert particles	Silicone	.030 [0.76]
CONSIL-C (873)			
(87-7xxxx)	Silver-plated copper particles	Silicone	.030 [0.76]
CONSIL-C (875)			
(87-5xxxx)	Silver-plated copper particles	Fluoro-silicone	.030 [0.76]
CONSIL-A (895)			
(89-5xxxx)	Silver-plated aluminum particles	Silicone	.030 [0.76]
CONSIL-A (897)			
(89-7xxxx)	Silver-plated aluminum particles	Fluoro-silicone	.030 [0.76]

*For material specifications and thickness tolerances see applicable material data sheet.



STANDARD CONNECTOR GASKETS
FLANGE, CONNECTOR SHELL SIZE

Table 1.

FLANGE, CONNECTOR SHELL SIZE		GASKET DIMENSIONS					*TECKNIT ORDER NUMBER
AN,HT & QWL	JT,PT & PC	A	B	C	D	R	
MIL-C-5015	MIL-C-26482	± .015	± .015	± .015	± .015	± .015	
MS-3100	MS-3110	[0.38]	[0.38]	[0.38]	[0.38]	[0.38]	
MS-3102	MS-3112						
	MS-3119						
	MS-3120						
SP							
	#6	0.688 [17.48]	0.375 [9.53]	0.469 [11.91]	.156 [3.96]	.109 [2.77]	XX-X1650
	#8	0.812 [20.62]	0.500 [12.70]	0.594 [15.09]	.156 [3.96]	.109 [2.77]	XX-X1651
#8		0.875 [22.23]	0.500 [12.70]	0.594 [15.09]	.172 [4.37]	.125 [3.18]	XX-X1408
	#10	0.938 [23.83]	0.625 [15.88]	0.719 [18.26]	.156 [3.96]	.109 [2.77]	XX-X1652
	#6	0.953 [24.21]	0.375 [9.53]	0.641 [16.28]	.172 [4.37]	.156 [3.96]	XX-X1653
#10		1.000 [25.40]	0.625 [15.88]	0.719 [18.26]	.172 [4.37]	.125 [3.18]	XX-X1411
	#12	1.031 [26.19]	0.750 [19.05]	0.813 [20.65]	.156 [3.96]	.109 [2.77]	XX-X1654
	#8	1.047 [26.59]	0.500 [12.70]	0.734 [18.64]	.172 [4.37]	.156 [3.96]	XX-X1655
#12		1.094 [27.79]	0.750 [19.05]	0.813 [20.65]	.172 [4.37]	.125 [3.18]	XX-X1415
	#14	1.125 [28.58]	0.875 [22.23]	0.906 [23.01]	.156 [3.96]	.109 [2.77]	XX-X1656
	#10	1.125 [28.58]	0.687 [17.45]	0.812 [20.62]	.172 [4.37]	.063 X 45° [1.60 X 45°]	XX-X1418
#14		1.188 [30.18]	0.875 [22.23]	0.906 [23.01]	.172 [4.37]	.125 [3.18]	XX-X1423
	#16	1.219 [30.96]	1.000 [25.40]	0.969 [24.61]	.156 [3.96]	.125 [3.18]	XX-X1657
	#12	1.250 [31.75]	0.781 [19.84]	0.938 [23.83]	.172 [4.37]	.156 [3.96]	XX-X1658
#16		1.281 [32.54]	1.000 [25.40]	0.969 [24.61]	.172 [4.37]	.125 [3.18]	XX-X1434
	#18	1.312 [33.32]	1.125 [28.58]	1.063 [27.00]	.156 [3.96]	.125 [3.18]	XX-X1659
	#14	1.344 [34.14]	0.875 [22.23]	1.031 [26.19]	.172 [4.37]	.156 [3.96]	XX-X1660
#18		1.375 [34.93]	1.125 [28.58]	1.063 [27.00]	.203 [5.16]	.125 [3.18]	XX-X1439
	#20	1.469 [37.31]	1.281 [32.54]	1.156 [29.36]	.156 [3.96]	.125 [3.18]	XX-X1448
	#16	1.438 [36.53]	1.000 [25.40]	1.125 [28.58]	.172 [4.37]	.156 [3.96]	XX-X1661
#20		1.500 [38.10]	1.250 [31.75]	1.156 [29.36]	.203 [5.16]	.125 [3.18]	XX-X1455
	#18	1.516 [38.51]	1.125 [28.58]	1.203 [30.56]	.172 [4.37]	.156 [3.96]	XX-X1662
	#22	1.563 [39.70]	1.375 [34.93]	1.250 [31.75]	.130 [3.30]	.156 [3.96]	XX-X1461
#22		1.625 [41.28]	1.375 [34.93]	1.250 [31.75]	.203 [5.16]	.125 [3.18]	XX-X1465
	#20	1.672 [42.47]	1.250 [31.75]	1.297 [32.94]	.172 [4.37]	.187 [4.75]	XX-X1663
	#24	1.688 [42.88]	1.500 [38.10]	1.375 [34.93]	.156 [3.96]	.156 [3.96]	XX-X1664
#24		1.750 [44.45]	1.500 [38.10]	1.375 [34.93]	.203 [5.16]	.125 [3.18]	XX-X1480
	#22	1.750 [44.45]	1.375 [34.93]	1.375 [34.93]	.172 [4.37]	.187 [4.75]	XX-X1478
	#24	1.875 [47.63]	1.500 [38.10]	1.500 [38.10]	.172 [4.37]	.187 [4.75]	XX-X1665
#28		2.000 [50.80]	1.750 [44.45]	1.563 [39.70]	.203 [5.16]	.125 [3.18]	XX-X1491
#32		2.250 [57.15]	2.000 [50.80]	1.750 [44.45]	.219 [5.56]	-	XX-X1496
#36		2.500 [63.50]	2.188 [55.58]	1.938 [49.23]	.219 [5.56]	.125 [3.18]	XX-X1505
#40		2.750 [69.85]	2.438 [61.93]	2.188 [55.58]	.219 [5.56]	.125 [3.18]	XX-X1509
#44		3.000 [76.20]	2.781 [70.64]	2.375 [60.33]	.219 [5.56]	.125 [3.18]	XX-X1144
#48		3.250 [82.55]	3.031 [76.99]	2.625 [66.68]	.219 [5.56]	.109 [2.77]	XX-X1148
RF CONNECTORS							
	BN & BNC	0.687 [17.45]	0.437 [11.10]	0.500 [12.70]	.100 [2.54]	.093 [2.36]	XX-X1402
	C & N	1.000 [25.40]	0.625 [15.88]	0.719 [18.26]	.172 [4.37]	.125 [3.18]	XX-X1411
	HN	1.188 [30.18]	0.750 [19.05]	0.906 [23.01]	.156 [3.96]	.140 [3.56]	XX-X1422
	UHF	1.281 [32.54]	1.000 [25.40]	0.969 [24.61]	.172 [4.37]	.125 [3.18]	XX-X1434
	LC	2.000 [50.50]	1.250 [31.75]	1.437 [36.50]	.265 [6.73]	.281 [7.14]	XX-X1666

*To form, a complete TECKNIT part no., substitute the appropriate material prefix from the Specifications Table for the "XX-X" in the above TECKNIT order number.



EMI Connector Gaskets, continued

COMMONLY USED CONNECTOR SIZES AND PART NUMBERS

Table 1.

U.S. Customary
[SI Metric]

GASKET DIMENSIONS						GASKET DIMENSIONS					
A ±.015 0.38	B ±.015 0.38	C ±.015 0.38	D ±.015 0.38	R ±.015 0.38	*TECKNIT ORDER NUMBER	A ±.015 0.38	B ±.015 0.38	C ±.015 0.38	D ±.015 0.38	R ±.015 0.38	*TECKNIT ORDER NUMBER
.687 [17.45]	.348 [8.84]	.500 [12.70]	.100 [2.54]	.093 [2.36]	XX-X1400	1.500 [38.10]	1.219 [30.96]	1.156 [29.36]	.156 [3.96]	.171 [4.34]	XX-X1454
.687 [17.45]	.348 [8.84]	.500 [12.70]	.109 [2.77]	.093 [2.36]	XX-X1401	1.500 [38.10]	1.281 [32.54]	1.156 [29.36]	.120 [3.05]	.187 [4.75]	XX-X1120
.687 [17.45]	.437 [11.10]	.500 [12.70]	.109 [2.77]	-	XX-X1403	1.500 [38.10]	1.240 [31.50]	1.160 [29.46]	.156 [3.96]	.160 [4.06]	XX-X1456
.750 [19.05]	.375 [9.53]	-	-	.062 [1.57]	XX-X1404	1.500 [38.10]	1.344 [34.14]*	1.188 [30.18]	.171 [4.34]	.187 [4.75]	XX-X1457
.750 [19.05]	.500 [12.70]	-	-	-	XX-X1405	1.516 [38.51]	1.250 [31.75]	1.203 [30.56]	.156 [3.96]	.125 [3.18]	XX-X1458
.800 [20.32]	.440 [11.18]	.500 [12.70]	.120 [3.05]	.150 [3.81]	XX-X1406	1.516 [38.51]	1.125 [28.58]	-	-	-	XX-X1459
.812 [20.62]	.385 [9.53]	.500 [12.70]	.128 [3.25]	-	XX-X1407	1.531 [38.89]	1.156 [29.36]	1.203 [30.56]	.125 [3.18]	-	XX-X1460
.875 [22.23]	.531 [13.49]	.594 [15.09]	.120 [3.05]	.062 [1.57]	XX-X1409	1.594 [40.49]	1.312 [33.32]	1.250 [31.75]	.173 [4.39]	-	XX-X1462
.953 [24.21]	.609 [15.47]	.719 [18.26]	.120 [3.05]	.125X45° [3.18X45°]	XX-X1410	1.594 [40.49]	1.406 [35.71]	1.250 [31.75]	.141 [3.58]	.125 [3.18]	XX-X1463
1.000 [25.40]	.656 [16.66]	.719 [18.26]	.120 [3.05]	.125 [3.18]	XX-X1110	1.625 [41.28]	1.375 [34.93]	1.250 [31.75]	.171 [4.34]	.188 [4.78]	XX-X1464
1.000 [25.40]	.703 [17.86]	.719 [18.26]	.156 [3.96]	-	XX-X1412	1.625 [41.28]	1.406 [35.71]	1.250 [31.75]	.120 [3.05]	.125 [3.18]	XX-X1466
1.031 [26.19]	.719 [18.26]	.719 [18.26]	.130 [3.30]	.156 [3.96]	XX-X1413	1.625 [41.28]	1.437 [36.50]	1.250 [31.75]	.120 [3.05]	.187 [4.75]	XX-X1467
1.094 [27.79]	.750 [19.05]	.812 [20.62]	.150 [3.81]	.140 [3.56]	XX-X1414	1.640 [41.66]	1.250 [31.75]	-	-	.35 X 45° [8.89 X 45°]	XX-X1468
1.094 [27.79]	.781 [19.84]	.812 [20.62]	.120 [3.05]	.125 [3.18]	XX-X1416	1.672 [42.47]	1.375 [34.93]	1.297 [32.94]	.125 [3.18]	.125 [3.18]	XX-X1469
1.094 [27.79]	.875 [22.23]	.812 [20.62]	.143 [3.63]	-	XX-X1417	1.688 [42.88]	1.385 [35.18]	1.297 [32.94]	.150 [3.81]	-	XX-X1470
1.125 [28.58]	.750 [19.05]	.812 [20.62]	.156 [3.96]	.125 [3.18]	XX-X1419	1.688 [42.88]	1.375 [34.93]	1.297 [32.94]	.150 [3.81]	.181 [4.60]	XX-X1471
1.160 [29.46]	.925 [23.50]	.906 [23.01]	.125 [3.18]	-	XX-X1420	1.687 [42.85]	1.312 [33.32]	1.312 [33.32]	.156 [3.96]	.156 [3.96]	XX-X1472
1.188 [30.18]	.984 [25.00]	.812 [20.62]	.156 [3.96]	.125 [3.18]	XX-X1421	1.735 [44.09]	1.560 [39.62]	1.312 [33.32]	.125 [3.18]	.200 [5.59]	XX-X1473
1.188 [30.18]	.906 [23.01]	.906 [23.01]	.120 [3.05]	.140 [3.56]	XX-X1114	1.470 [44.20]	1.439 [36.55]	1.312 [33.32]	.136 [3.45]	-	XX-X1474
1.188 [30.18]	.938 [23.83]	.906 [23.01]	.120 [3.05]	.141 [3.58]	XX-X1424	1.750 [44.45]	1.281 [32.54]	1.297 [32.94]	.173 [4.39]	.226 [5.74]	XX-X1475
1.188 [30.18]	.950 [24.13]	.906 [23.01]	.120 [3.05]	.125 [3.18]	XX-X1425	1.750 [44.45]	1.562 [39.67]	1.312 [33.32]	.140 [3.56]	.125 [3.18]	XX-X1476
1.188 [30.18]	1.000 [25.40]	.969 [24.61]	.065 [1.65]	-	XX-X1426	1.750 [44.45]	1.500 [38.10]	1.312 [33.32]	.125 [3.18]	.156 [3.96]	XX-X1477
1.203 [30.58]	.875 [22.23]	.906 [23.01]	.125 [3.18]	.063X45° [1.60X45°]	XX-X1427	1.750 [44.45]	1.500 [38.10]	1.375 [34.92]	.125 [3.18]	.125 [3.18]	XX-X1479
1.250 [31.75]	.875 [22.23]	.938 [23.83]	.156 [3.96]	.125 [3.18]	XX-X1428	1.750 [44.45]	1.531 [38.89]	1.375 [34.92]	.147 [3.73]	.125 [3.18]	XX-X1124
1.265 [32.13]	.875 [22.23]	-	-	-	XX-X1429	1.750 [44.45]	1.500 [38.10]	1.375 [34.92]	.109 [2.77]	.188 [4.78]	XX-X1481
1.265 [32.13]	.937 [23.80]	.906 [23.01]	.140 [3.56]	-	XX-X1430	1.781 [45.24]	1.594 [40.49]	1.438 [36.53]	.136 [3.45]	.062 [1.57]	XX-X1482
1.266 [32.16]	.781 [19.84]	.938 [23.83]	.125 [3.18]	-	XX-X1431	1.800 [45.72]	1.440 [36.58]	1.380 [35.05]	.204 [5.18]	.093 [2.36]	XX-X1483
1.281 [32.54]	.875 [22.23]	.969 [24.61]	.150 [3.81]	.160 [4.06]	XX-X1432	1.812 [46.02]	1.560 [39.62]	1.312 [33.32]	.125 [3.18]	.250 [6.35]	XX-X1484
1.281 [32.54]	.875 [22.23]	.969 [24.61]	.146 [3.71]	.188 [4.78]	XX-X1433	1.812 [46.02]	1.375 [34.93]	-	-	-	XX-X1485
1.281 [32.54]	1.031 [26.19]	.969 [24.61]	.120 [3.05]	.125 [3.18]	XX-X1116	1.875 [47.63]	1.625 [41.28]	1.500 [38.10]	.156 [3.96]	.125 [3.18]	XX-X1486
1.281 [32.54]	1.063 [27.00]	.969 [24.61]	.120 [3.05]	.156 [3.96]	XX-X1435	1.875 [47.63]	1.531 [38.89]	1.375 [34.92]	.109 [2.77]	.250 [6.35]	XX-X1487
1.344 [34.14]	1.000 [25.40]	1.031 [26.19]	.156 [3.96]	.125 [3.18]	XX-X1436	1.950 [49.53]	1.500 [38.10]	-	-	-	XX-X1488
1.360 [34.54]	.870 [22.10]	1.030 [26.16]	.120 [3.05]	.120 [3.05]	XX-X1437	2.000 [50.80]	1.437 [36.50]	1.437 [36.50]	.257 [6.53]	.125 [3.18]	XX-X1489
1.375 [34.93]	1.000 [25.40]	1.063 [27.00]	.128 [3.25]	.156 [3.96]	XX-X1438	2.000 [50.80]	39.80 [1.567]	1.437 [38.50]	.257 [6.53]	.125 [3.18]	XX-X1490
1.375 [34.93]	1.156 [29.36]	1.063 [27.00]	.120 [3.05]	.188 [4.76]	XX-X1118	2.000 [50.80]	1.781 [45.24]	1.563 [39.70]	.147 [3.73]	.218 [5.54]	XX-X1128
1.375 [34.93]	1.188 [30.18]	1.063 [27.00]	.120 [3.05]	.156 [3.96]	XX-X1440	2.000 [50.80]	1.781 [45.24]	1.563 [39.70]	.188 [4.76]	.125 [3.18]	XX-X1492
1.375 [34.93]	1.000 [25.40]	1.062 [26.97]	.166 [4.22]	.166 [4.22]	XX-X1441	2.070 [52.58]	1.625 [41.28]	-	-	-	XX-X1493
1.375 [34.93]	1.000 [25.40]	-	-	-	XX-X1442	2.125 [53.98]	1.688 [42.88]	1.688 [42.88]	.195 [4.95]	.218 [5.54]	XX-X1494
1.406 [35.71]	1.000 [25.40]	1.000 [25.40]	.177 [4.50]	.201 [5.11]	XX-X1443	2.250 [57.15]	1.843 [46.81]	1.750 [44.45]	.219 [5.56]	-	XX-X1495
1.406 [35.71]	1.125 [28.58]	1.062 [26.97]	.149 [3.78]	.125 [3.18]	XX-X1444	2.250 [57.15]	2.000 [50.80]	1.750 [44.45]	.219 [5.56]	.125 [3.18]	XX-X1497
1.437 [36.49]	1.062 [26.97]	1.125 [28.58]	.156 [3.96]	.156 [3.96]	XX-X1445	2.250 [57.15]	2.031 [51.59]	1.750 [44.45]	.173 [4.39]	.125 [3.18]	XX-X1498
1.437 [36.49]	1.125 [28.58]	1.125 [28.58]	.156 [3.96]	.125 [3.18]	XX-X1446	2.250 [57.15]	2.031 [51.59]	1.750 [44.45]	.219 [5.56]	.125 [3.18]	XX-X1499
1.437 [36.49]	1.250 [31.75]	1.188 [30.18]	.125 [3.18]	.125 [3.18]	XX-X1447	2.281 [57.94]	2.015 [51.18]	1.688 [42.88]	.219 [5.56]	.125 [3.18]	XX-X1500
1.469 [36.49]	1.312 [33.32]	1.188 [30.18]	.125 [3.18]	.156 [3.96]	XX-X1449	2.375 [60.33]	2.032 [51.61]	1.688 [42.88]	.125 [3.18]	.250 [6.35]	XX-X1501
1.500 [38.10]	.875 [22.23]	1.062 [26.97]	.177 [4.50]	-	XX-X1450	2.500 [63.50]	1.250 [31.75]	1.750 [44.45]	.312 [7.92]	-	XX-X1502
1.500 [38.10]	1.000 [25.40]	1.125 [28.58]	.188 [4.78]	-	XX-X1451	2.500 [63.50]	1.625 [41.28]	1.750 [44.45]	.312 [7.92]	-	XX-X1503
1.500 [38.10]	1.031 [26.19]	1.125 [28.58]	.173 [4.39]	.188 [4.78]	XX-X1452	2.500 [63.50]	2.250 [57.15]	1.852 [47.04]	.177 [4.50]	.312 [7.92]	XX-X1504
1.500 [38.10]	1.140 [28.96]	1.156 [29.36]	.120 [3.05]	.171 [4.34]	XX-X1453	2.500 [63.50]	2.281 [57.94]	1.983 [49.23]	.173 [4.39]	.093 [2.36]	XX-X1136



COMMONLY USED CONNECTOR SIZES AND PART NUMBERS, CONT.

Table 2.

GASKET DIMENSIONS						GASKET DIMENSIONS					
A ±.015 0.38	B ±.015 0.38	C ±.015 0.38	D ±.015 0.38	R ±.015 0.38	*TECKNIT ORDER NUMBER	A ±.015 0.38	B ±.015 0.38	C ±.015 0.38	D ±.015 0.38	R ±.015 0.38	*TECKNIT ORDER NUMBER
2.500 [63.50]	2.281 [57.94]	1.983 [49.23]	.281 [7.14]	.093 [2.36]	XX-X1506	3.265 [82.93]	3.035 [77.09]	2.531 [64.29]	.296 [7.52]	.312 [7.92]	XX-X1515
2.625 [66.68]	2.188 [55.58]	2.093 [53.16]	.221 [5.61]	.266 [6.76]	XX-X1507	3.281 [83.34]	3.015 [76.58]	2.531 [64.29]	.281 [7.14]	.125 [3.18]	XX-X1516
2.690 [68.33]	2.250 [57.15]	2.250 [57.15]	.201 [5.11]	.125 X 45° [3.18 X 45°]	XX-X1508	3.375 [85.73]	2.138 [79.71]	2.475 [62.87]	.166 [4.22]	1.000 [25.40]	XX-X1517
2.750 [69.85]	2.531 [64.29]	2.188 [55.58]	.173 [4.39]	.125 [3.18]	XX-X1140	3.812 [96.82]	3.125 [79.38]	3.250 [82.55]	.312 [7.92]	-	XX-X1518
2.750 [69.85]	2.531 [64.29]	2.234 [56.74]	.173 [4.39]	.26 X 45° [6.60 X 45°]	XX-X1510	4.000 [101.60]	2.000 [50.80]	3.000 [72.20]	.281 [7.14]	-	XX-X1519
2.765 [70.23]	2.515 [63.88]	2.085 [52.96]	.236 [5.99]	.250 [6.60]	XX-X1511	4.500 [114.30]	3.000 [76.20]	3.800 [96.52]	.250 [6.35]	.35 X 45° [8.89 X 45°]	XX-X1521
2.781 [70.64]	2.500 [63.50]	2.234 [56.74]	.166 [4.22]	FULL	XX-X1512	4.500 [114.30]	4.000 [101.60]	3.875 [98.43]	.281 [7.14]	.312 [7.92]	XX-X1522
2.875 [73.03]	2.531 [64.29]	2.094 [53.19]	.138 [3.51]	.250 [6.60]	XX-X1513	4.625 [117.48]	3.888 [98.76]	-	-	-	XX-X1523
2.875 [73.03]	2.500 [63.50]	2.500 [63.50]	.154 [3.91]	.188 [4.78]	XX-X1514						

*To form a complete TECKNIT part no., substitute the appropriate material prefix from Specifications Table for the "XX-X" in the above TECKNIT order number.

STANDARD CONNECTOR GASKETS

Table 3.

CONNECTOR SHELL SIZE		GASKET DIMENSIONS						E** [0.38]	TECKNIT* ORDER NUMBER
MIL-C-38999 NUMBER	± .015 SERIES	A +.020 [0.38]	B ± .015 -0.00 [+ 0.51,-000]	C ± .015 [0.38]	D ± .015 [0.38]	R ± .015 [0.38]			
8	II	.840 [21.34]	.630 [16.00]	.594 [15.09]	.135 [3.43]	.125 [3.18]		XX-X1616	
9	I	.965 [24.51]	.750 [19.05]	.719 [18.26]	.135 [3.43]	.125 [3.18]		XX-X1617	
9A	III	.965 [24.51]	.750 [19.05]	.719 [18.26]	.135 [3.43]	.125 [3.18]	.222[5.64]	XX-X1640	
10	II	.965 [24.51]	.750 [19.05]	.719 [18.26]	.135 [3.43]	.125 [3.18]		XX-X1617	
11	I & IV	1.060 [26.92]	.875 [22.23]	.812 [20.62]	.141 [3.58]	.125 [3.18]		XX-X1618	
11B	III	1.060 [26.92]	.875 [22.23]	.812 [20.62]	.141 [3.58]	.125 [3.18]	.206 [5.23]	XX-X1641	
12	II	1.060 [26.92]	.875 [22.23]	.812 [20.62]	.141 [3.58]	.125 [3.18]		XX-X1618	
13	I & IV	1.153 [29.29]	1.005 [25.53]	.906 [23.01]	.135 [3.43]	.125 [3.18]		XX-X1619	
13C	III	1.153 [29.29]	1.005 [25.53]	.906 [23.01]	.135 [3.43]	.125 [3.18]	.206 [5.23]	XX-X1642	
14	II	1.153 [29.29]	1.005 [25.53]	.906 [23.01]	.135 [3.43]	.125 [3.18]		XX-X1619	
15	I & IV	1.258 [31.95]	1.135 [28.83]	.969 [24.61]	.156 [3.96]	.141 [3.58]		XX-X1620	
15D	III	1.258 [31.95]	1.135 [28.83]	.969 [24.61]	.156 [3.96]	.141 [3.58]	.206 [5.23]	XX-X1643	
16	II	1.258 [31.95]	1.135 [28.83]	.969 [24.61]	.156 [3.96]	.141 [3.58]		XX-X1620	
17	I & IV	1.351 [34.32]	1.260 [32.00]	1.062 [26.97]	.156 [3.96]	.141 [3.58]		XX-X1621	
17E	III	1.351 [34.32]	1.260 [32.00]	1.062 [26.97]	.156 [3.96]	.141 [3.58]	.222 [5.64]	XX-X1644	
18	II	1.351 [34.32]	1.260 [32.00]	1.062 [26.97]	.156 [3.96]	.141 [3.58]		XX-X1621	
19	I & IV	1.500 [38.10]	1.375 [34.93]	1.156 [29.36]	.141 [3.58]	.172 [4.37]		XX-X1622	
19F	III	1.500 [38.10]	1.375 [34.93]	1.156 [29.36]	.141 [3.58]	.172 [4.37]	.206 [5.23]	XX-X1645	
20	II	1.500 [38.10]	1.375 [34.93]	1.156 [29.36]	.141 [3.58]	.172 [4.37]		XX-X1622	
21	I & IV	1.625 [41.28]	1.500 [38.10]	1.250 [31.75]	.141 [3.58]	.188 [4.78]		XX-X1623	
21G	III	1.625 [41.28]	1.500 [38.10]	1.250 [31.75]	.141 [3.58]	.188 [4.78]	.206 [5.23]	XX-X1646	
22	II	1.625 [41.28]	1.500 [38.10]	1.250 [31.75]	.141 [3.58]	.188 [4.78]		XX-X1623	
23	I & IV	1.750 [44.45]	1.625 [41.28]	1.375 [34.93]	.172 [4.37]	.188 [4.78]		XX-X1624	
23H	III	1.750 [44.45]	1.625 [41.28]	1.375 [34.93]	.172 [4.37]	.188 [4.78]	.259 [6.58]	XX-X1647	
24	II	1.750 [44.45]	1.625 [41.28]	1.375 [34.93]	.172 [4.37]	.188 [4.78]		XX-X1624	
25	I & IV	1.875 [47.63]	1.750 [44.45]	1.500 [38.10]	.172 [4.37]	.188 [4.78]		XX-X1625	
25J	III	1.875 [47.63]	1.750 [44.45]	1.500 [38.10]	.172 [4.37]	.188 [4.78]	.259 [6.58]	XX-X1648	

* To form a complete TECKNIT part no., substitute the appropriate material suffix from the SPECIFICATIONS TABLE for the "XX-X" in the TECKNIT order number.

**Required for Series III only. At TECKNIT's option dimension "E" may be slotted through to Hole "B" (see Figure 2).

